



## TURNTABLE HI-FI SYSTEM WITH SPEAKERS



1byone Products Inc.  
1230 E Belmont Street, Ontario, CA, USA 91761  
Customer Service: +1 909-391-3888  
[www.1byonebros.com](http://www.1byonebros.com)

Made in China

**Instruction Manual**

## INTRODUCTION

Thank you for purchasing the 1byone Integrated Turntable for Vinyl Record. This instruction manual contains important information about its safety, usage and disposal. Use the product as described and keep this manual for future reference. If you sell this turntable or pass it on, please also give this manual to the new owner.

## SAFETY INSTRUCTION

1. Please follow the instructions in the manual for the proper use of this product.
2. Avoid exposing the product to rain, moisture, dripping, or splashing water.
3. Ensure that the power voltage matches the voltage indicated on the product.
4. Do not modify the plug in any way.
5. Avoid pulling, bending, stepping on, or squeezing the power cord.
6. Assemble the product according to this manual, and do not place any objects on the product.
7. Prevent any objects or liquids from entering the turntable body, as they may come into contact with hazardous voltage points or cause components to short circuit, leading to fire or electric shock.
8. Do not attempt to repair the turntable or remove the body panel by yourself. Leave all maintenance work to qualified service personnel.
9. Do not use any turntable replacement parts or components not approved by the manufacturer in this product.
10. Do not place the product near any high-temperature areas or open flames. Place the product on a flat and stable surface, and handle it with care during moving or transportation to prevent overturning and collisions that may cause damage.
11. The slots and openings on the body ensure ventilation and reliable operation of the product, preventing excessive heat. Do not block or cover these openings.
13. Unplug the power cord during thunderstorms or when the product is not in use for an extended period.



## Compliance with FCC Regulation

This device complies with Part 15 of FCC rules. Operation is subject to the following two conditions:

- (1) This device may not cause harmful interference, and
- (2) This device must accept any interference received, including interference that may cause undesired operation.

This equipment has been tested and found to comply with the limits for a Class B digital device, pursuant to Part 15 of the FCC rules. These limits are designed to provide reasonable protection against harmful interference in a residential installation.

This equipment generates, uses and can radiate radio frequency energy and, if not installed and used in accordance with the instructions, may cause harmful interference to radio communications. However, there is no guarantee that interference will not occur in a particular installation.

If this equipment does cause harmful interference to radio or television reception, which can be determined by turning the equipment off and on, the user is encouraged to try to correct the interference by one or more of the following measures:

- Reorient or relocate the receiving antenna.
- Increase the separation between the equipment and receiver.
- Connect the equipment into an outlet on a circuit different from that to which the receiver is connected.
- Consult the dealer or an experienced radio/TV technician for help.

RF Exposure Statement:

When using the product, maintain a distance of 20cm from the body to ensure compliance with RF exposure requirements.

**WARNING:** Changes or modifications to this unit not expressly approved by the party responsible for compliance could void the user's authority to operate the equipment.

**WARNING:** Cancer and Reproductive Harm - <http://www.P65Warnings.ca.gov>  
For more information go to <http://www.1byonebros.com/Compliance/Prop65>

## PRODUCT DESCRIPTION

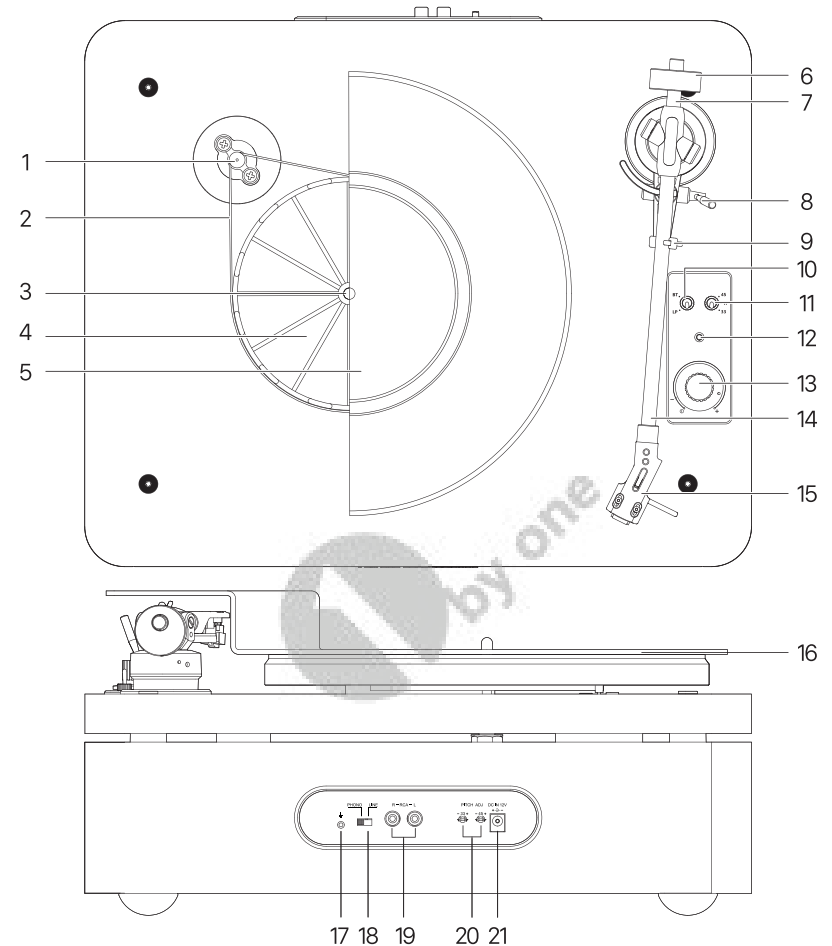

- |                          |                       |                             |
|--------------------------|-----------------------|-----------------------------|
| 1. Motor pulley          | 8. Tonearm Lift Lever | 15. Stylus Cartridge        |
| 2. Drive Belt            | 9. Tonearm Clip       | 16. Protective cover        |
| 3. Turntable Spindle     | 10. Function switch   | 17. Ground Connector        |
| 4. Turntable Sub-platter | 11. 33/45RPM Selector | 18. Phono & Line Out Switch |
| 5. Turntable Platter     | 12. Indicator light   | 19. Phono & Line Out Jacks  |
| 6. Counterweight         | 13. Volume Control    | 20. Speed fine adjustment   |
| 7. Balance bar           | 14. Tonearm Rest      | 21. DC INPUT Jack           |

## INCLUDED ITEMS

Before installation, please check that the following components are included and undamaged. Keep the original packaging for potential returns or exchange.

- |                     |                              |
|---------------------|------------------------------|
| 1) Turntable Body   | 7) Sub Platter               |
| 2) Power Adapter    | 8) Belt                      |
| 3) Protective cover | 9) Counterweight             |
| 4) The cover base.  | 10) Cartridge Alignment Card |
| 5) Anti-slip Mat    | 11) 45 RPM Record Adapter    |
| 6) Main Platter     | 12) User Manual              |

Note: The turntable is factory-equipped with a pre-aligned cartridge. Instructions for adjusting the cartridge, as provided in the manual, are intended for use when replacing the cartridge.

## INSTALLING THE TURNTABLE

Note: Do not apply power before completing the assembly.

- Mount the product on a level surface.
- To avoid the effects of vibrations and acoustic pressure, do not mount the product next to such items as speakers.
- The product may pick up radio static if placed next to a radio. Therefore, try to keep the product away from radios.
- If the product is near equipment (cell phone, etc.) that emits strong radio waves, noise may occur.

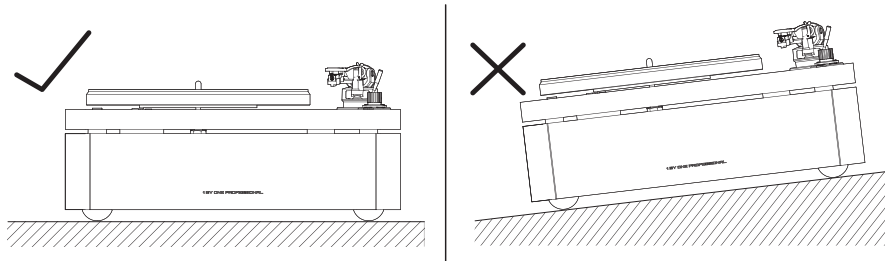

4

## REMOVE THE CARTRIDGE DAMPING PAD

Pull out the four shock-absorbing pads of the turntable and place them properly. Reinsert the shock-absorbing pads into their original positions the next time you transport the turntable.

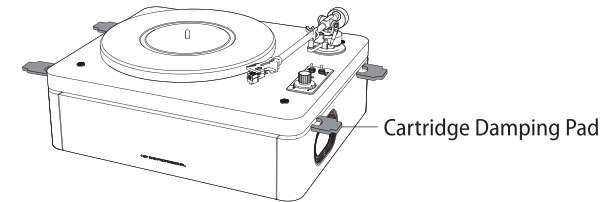

## TURNTABLE PLATTER AND BELT SETUP

1. Put the belt on the motor pulley and the sub platter in the correct position as shown in the figure, taking care not to twist the belt.

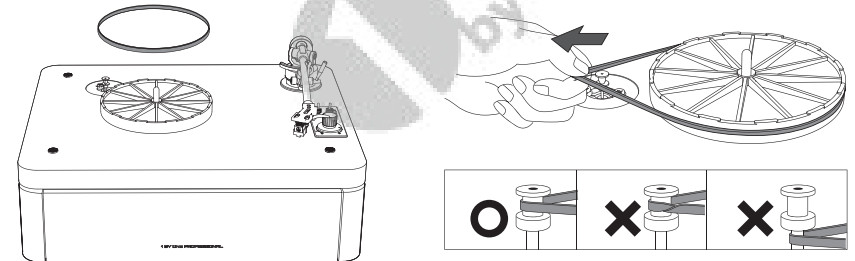

2. Manually rotate the sub platter clockwise about 10 circles.  
- Check if the belt is twisted or detached to ensure smooth operation of the turntable drive system.

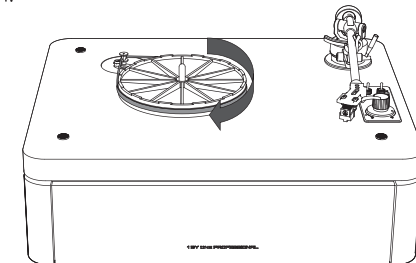

5

3. Carefully place the main platter on top of the sub-platter.

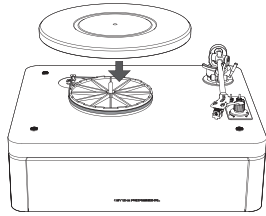

4. Place the slip mat on the platter with the **1 by one** facing up.

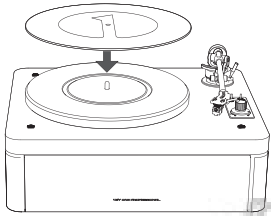

## CARTRIDGE TRACKING FORCE ADJUSTMENT

1. Gently push the counterweight onto the rear of the tonearm.

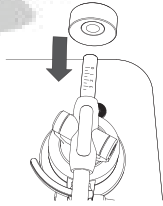

2. Carefully push and pull the Counterweight and stop when it reaches the tick mark of recommended tracking force.

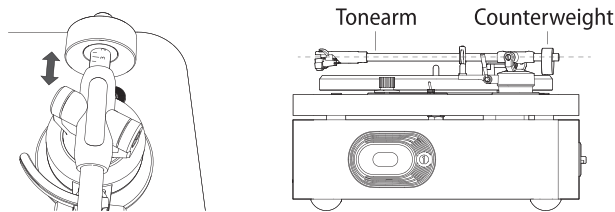

**Note:** Each mark on the dial represents 0.5g. The recommended tracking force for the factory-installed cartridge is  $2.5g \pm 0.5$ .

3. If the counterweight loosens or moves during the usage, please gently turn the screw to make it tight again.

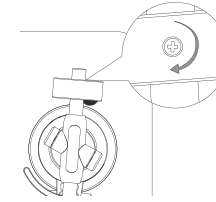

## INSTALLING THE TURNTABLE DUST COVER

When the turntable is working: remove the dust cover and put on the record.

When the turntable is not working: remove the record and put on the dust cover to protect the tonearm and platter.

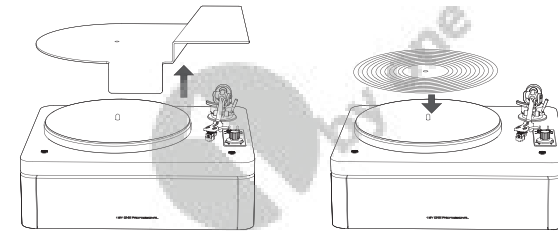

## CONNECTION TO EXTERNAL SPEAKERS WITH RCA

This product includes 4 built-in speakers and a built-in phono equalizer. If you want to use your own amplifier or speakers, please follow the instructions below:

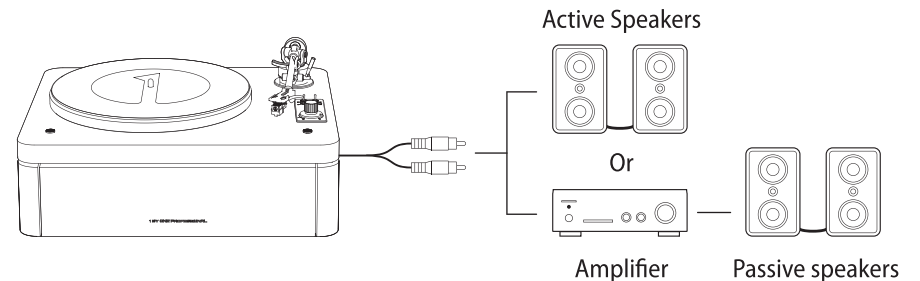

**Note:** In order to achieve the best sound, it is advised to set the turntable volume to a minimal level. Then the turntable's audio will be played back through your own amplifier, speakers, etc.

### 1. Set the preamplifier selector switch (PHONO/LINE output selection)

This product has a built-in phono equalizer function. You can use the product even if you do not have a phono amplifier or connectable equipment with a built-in phono amplifier.

Use the Phono & Line Out Switch to set the output, as shown below.

Connected equipment being used	Position of the Phono & Line Out Switch	Where to connect RCA audio cable
Device with phono input	PHONO	Phono input jack and ground (earth) terminal of connected equipment
Device without phono input	LINE	AUX or line input jack of connected equipment

**Note:** The RCA Jacks are not designed to be connected directly to the passive/unpowered speakers on LINE mode. If connected to the passive speakers, there will be no sound.

If you need to use passive speakers, please use a separate power amplifier.

### 2. Connecting the Device

Align the settings for the Phono & Line Out Switch and connect the RCA audio cable to an input jack that is compatible with the connectable equipment you are using (amplifier, active speakers, etc.).

- **The RCA audio cable's red jack is for the right (R) channel, and the white jack is for the left (L) channel.**

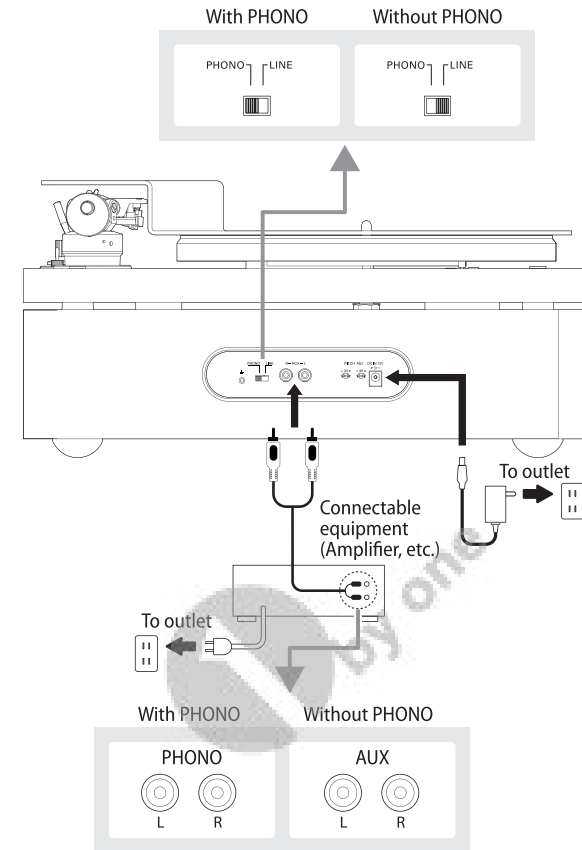

### MAIN POWER CONNECTION

1. Insert the end of the power adapter into the power port on the back panel of the turntable.
2. Insert the plug into the socket.

**Note:** Do not insert the AC power adapter into the power outlet before the product is fully assembled. Before turning on the turntable, please double-check and make sure all connections are correct. Be sure to turn off the turntable before connecting or disconnecting the power.

## PLAYING A RECORD

### 1. Before playing a record

1.1 Pull the protector straight forward to remove it.

**Note:** Applying a downward force may cause the stylus to come off the body. Only low volume is out putted if the stylus has come off, or is about to come off, so refer to "Replacing the stylus" to reattach the stylus correctly.

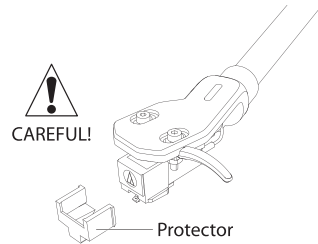

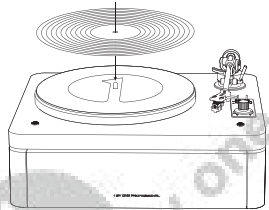

1.2 Place the record on the felt mat so that the center hole aligns with the spindle.



### 2. Turntable Operation

First, turn down the volume of your external amplifier or speakers as low as possible. Wait until the stylus is completely on the vinyl record before turning up the volume.

- 2.1 Connect the power adapter and power supply, turn the power/volume knob of the record player clockwise to  and turn it on when you hear a "click" sound, and the white indicator light will light up.
- 2.2 Remove the protective cover from the stylus horizontally.
- 2.3 Place the record on the slip mat. If you are playing a 7-inch 45RPM vinyl record, first place the included 45RPM record adapter on the spindle.
- 2.4 Flick the speed switch to select 33 or 45 revolutions per minute according to the record category, and the platter will start rotating clockwise.
- 2.5 Unlock the tonearm lock and make sure the tonearm lift lever is in the raised position before playing the record.
- 2.6 Place the tonearm on the desired position (groove) of the record.
- 2.7 Lower the lift lever to allow the tonearm to slowly drop onto the record.
- 2.8 Adjust the volume of the turntable as needed.

- 2.9 After playing the record, lift the tonearm lift lever, put the tonearm back on the bracket and lock it, turn the speed switch to the  position, the platter stops rotating, turn the power/volume knob to the  position to turn off the turntable, the indicator light goes out.

#### **Note:**

1. If the silent pause between tracks exceeds 3 minutes, the platter will automatically stop rotating to avoid damaging the record.
2. If the slip mat is dirty, it can easily scratch the record, please remove the slip mat regularly to wipe off the dust.
3. To prevent the record from being scratched and warped, please remove it and store it after use.
4. Do not use a record stabilizer.
5. After use, make sure the tonearm is latched to avoid any damage.
6. After use, don't forget to turn off the power of the turntable and external devices.

## BLUETOOTH OPERATION

1. Connect the power adapter and connect it to the power supply, turn the turntable power/volume knob clockwise to  and hear a "click" to turn it on, and the white indicator light will turn on.
2. Turn the function switch to BT Bluetooth mode. The indicator light turns blue and flashes quickly.
3. Turn on the Bluetooth of another media device, search and select "1byone S02" to start pairing.
4. After the media device is successfully paired with the turntable, the blue indicator light will turn to a solid light.
5. Play music from another media device through the turntable.
6. Adjust the volume knob to select the volume you want.

#### **Note: Bluetooth version 5.0**

## CARE

### Turntable Body

- When the turntable body is dirty or dusty, first disconnect the AC adapter and then wipe off the dirt and dust with a soft, dry cloth.
- Do not use benzenes, thinners, etc.
- When storing the product for a long time, disconnect the AC adapter from the outlet and wrap the product in plastic. Do not allow the product or packaging to become damp. The drive belt should be removed to prevent unequal stretching.

### Stylus Tip

- If dirt and grime are stuck to the stylus tip, clean it with a commercially sold brush.
- We recommend using a stylus cleaner (not included) if the stylus tip is considerably dirty. Clean the stylus tip by moving the brush from therear to the front of the stylus tip.

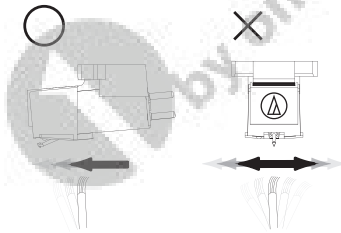

## REPLACING THE STYLUS

**It's suggested to replace the stylus after 400 hours of use.**

### Removing the Stylus

- In addition to the deterioration of sound quality, records may also be damaged as the cartridge's stylus tip wears down.
- Be sure to disconnect the product's AC adapter from the outlet.
- When replacing the stylus, hold the headshell and the cartridge body tightly.
- Rotate the front of the stylus in a forward and down motion.

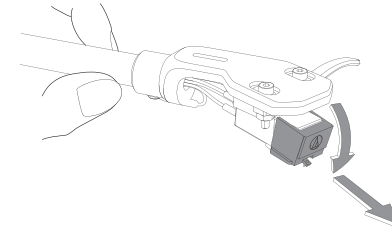

### Installing a New Replacement Stylus

1. Mount the new replacement stylus to the cartridge.

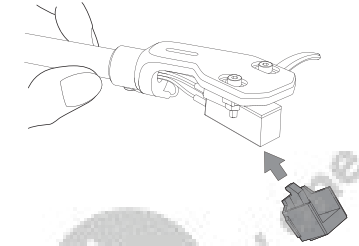

2. Lift the stylus up until you hear a click.

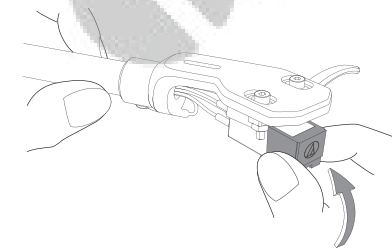

3. Make sure there is no gap between the headshell and the cartridge.

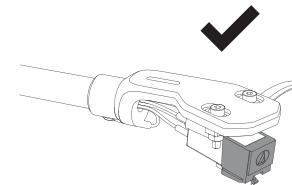

Proper Example

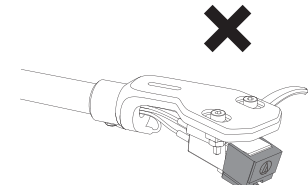

Improper Example



## WHEN THE TURNTABLE IS MOVED

Using the product's original packing materials, wrap the turntable in the reverse order from when you unwrapped it. If you do not have the packaging materials, take the following measures:

- After disconnecting the AC adapter from the outlet, remove the felt mat and platter, and then wrap them so that they do not get damaged.
- Attach the protector to the cartridge.
- Use a string or something similar to tie the tonearm to the rest so that it does not become dislodged.
- Wrap the turntable body with paper or a soft cloth so that it does not get damaged.

## TROUBLESHOOTING

Problem	Solution
The platter does not spin.	<ul style="list-style-type: none"> <li>• Is the AC adapter connected to the outlet?               <ul style="list-style-type: none"> <li>- Connect the AC adapter to the outlet.</li> <li>- Check if the speed selector is in the pause position.</li> </ul> </li> <li>• What's the status of the indicator light?               <ul style="list-style-type: none"> <li>- The indicator light is not on. Please follow the operating steps to power on correctly. After turning on the power switch, select the appropriate speed to start the platter.</li> <li>- The indicator light is blue. That means the turntable is in Bluetooth mode. Please turn the Function knob to switch to Turntable mode.</li> </ul> </li> <li>• Has the belt slipped from the platter?               <ul style="list-style-type: none"> <li>- Correctly place the belt on the platter.</li> </ul> </li> <li>• Is the motor working?               <ul style="list-style-type: none"> <li>- If the installation and operation are correct, check if the motor pulley is rotating.</li> </ul> </li> </ul>

The platter spins, but there is no sound from the turntable?	<ul style="list-style-type: none"> <li>• Are the wiring connections and function settings incorrect?               <ul style="list-style-type: none"> <li>- Ensure the PHONO/LINE switch on the turntable matches the input jack type of the audio device the turntable is connected to.</li> <li>- Check the wiring connections between the turntable and audio device, as well as the function and volume settings on the devices.</li> </ul> </li> <li>• Is the stylus damaged?               <ul style="list-style-type: none"> <li>- If necessary, replace the stylus. It is recommended to change the stylus every 400 hours of use.</li> </ul> </li> <li>• Is the stylus correctly installed on the cartridge?               <ul style="list-style-type: none"> <li>- Check that the stylus is properly installed on the cartridge.</li> </ul> </li> </ul>
The stylus skips.	<ul style="list-style-type: none"> <li>• Is the record warped?               <ul style="list-style-type: none"> <li>- Check the condition of the record.</li> </ul> </li> <li>• Is the record scratched or worn?               <ul style="list-style-type: none"> <li>- Inspect the record for scratches or wear.</li> </ul> </li> <li>• Is the tracking force set correctly?               <ul style="list-style-type: none"> <li>- Please refer to the instruction manual and properly adjust the tracking force on the tonearm as directed.</li> </ul> </li> <li>• Is the stylus damaged?               <ul style="list-style-type: none"> <li>- If necessary, replace the stylus. It is recommended to change the stylus</li> </ul> </li> </ul>
The turntable is making a strange 'howling' sound.	<ul style="list-style-type: none"> <li>• Is the product picking up excessive vibrations from the floor, surfaces of the walls, or nearby speakers?               <ul style="list-style-type: none"> <li>- Decrease the vibrations or mount the product on a surface that is not subject to the effects of vibrations.</li> </ul> </li> <li>• Is the product mounted on an unstable surface?               <ul style="list-style-type: none"> <li>- Check whether the surface on which the product is mounted is suitable.</li> </ul> </li> </ul>
There is noise when the record is playing.	<ul style="list-style-type: none"> <li>• Is there dust buildup on the stylus tip?               <ul style="list-style-type: none"> <li>- Use a professional stylus cleaning brush to clean the stylus.</li> </ul> </li> <li>• Is there dust or scratches on the vinyl record?               <ul style="list-style-type: none"> <li>- Please use a commercially available record cleaning product to wipe the surface clean, or replace the vinyl record.</li> </ul> </li> <li>• Is the tracking force set correctly?               <ul style="list-style-type: none"> <li>- Please refer to the instruction manual and properly adjust the tracking force on the tonearm as directed.</li> </ul> </li> </ul>

The sound when the record is playing is either too fast or too slow.	<ul style="list-style-type: none"> <li>Is the belt installed correctly? <ul style="list-style-type: none"> <li>Please refer to the belt installation section in the manual for proper installation.</li> </ul> </li> <li>Is the belt overstretched? <ul style="list-style-type: none"> <li>Replace with a new belt.</li> </ul> </li> </ul>
Playback speed slows down or there is irregular rotation.	<ul style="list-style-type: none"> <li>Is the speed setting on the turntable correct? <ul style="list-style-type: none"> <li>Please select the correct speed according to the type of record being played.</li> </ul> </li> <li>If the speed is still abnormal: <ul style="list-style-type: none"> <li>You can adjust the speed using the pitch control screw located on the back of the turntable.</li> </ul> </li> </ul>
Does the arm automatically go onto the record by itself to play and vice versa?	<ul style="list-style-type: none"> <li>This is not an automatic turntable. You need to manually move the tonearm onto the record or back to the tonearm rest.</li> </ul>
The stylus is not able to touch the record	<ul style="list-style-type: none"> <li>Check if the tonearm lift is not lowering properly. Manually raise and lower the tonearm lift about 10 times to allow the lubricant inside to distribute evenly, then it should be able to lower down onto the record.</li> </ul>

## THE SPEED IS TOO FAST OR TOO SLOW

After ruling out the other potential issues that could affect the turntable speed, you can adjust the pitch control screw. Power on the turntable and select either 33rpm or 45rpm speed. With the platter spinning, locate the pitch control screw on the back of the turntable. Carefully use a flathead/Phillips screwdriver to turn the corresponding screw to adjust the speed.

### PITCH ADJ

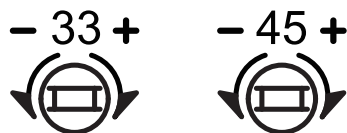

## SPECIFICATIONS

### Turntable

Model	1-AD07US21
Power supply	DC Output 15V 2000mA
Power Consumption	30W
Turntable Speed	33 1/3, 45RPM
Output Power (RMS)	12W x 2(BT), 12W x 2(PH)
Dimensions(LxWxH)	420x358x200mm
Weight	9.46Kg

### Cartridge

Model	Audio-Technica AT3600L
Frequency Response	20Hz-20kHz
Channel Balance	20/15 (dB at 1 kHz/10 kHz)
Channel Separation	Within 1.5 dB
Output Voltage	4.2mV (1 kHz, 5cm/sec)
Recommended Load Resistance	47kΩ
Amplifier Connection	MM (Moving Magnet)-input
Recommended Tracking Force	2.5±0.5g
Weight	0.18oz (5.1g)

**Note: Design and specifications are subject to change without notice.**

## DISPOSAL

### Disposal of the Product



Under no circumstances should you dispose of this product in normal domestic waste. This product is subject to the provisions of European Directive 2012/19/EU.

Dispose of this product via an approved disposal company or your municipal waste facility. Please observe currently applicable regulations. Please contact your waste disposal center if you need any further information.



This product's packaging is made from environmentally friendly material and can be disposed of at your local recycling plant.

## Customer Service

<b>UNITED KINGDOM</b>	Email: ukhelp@1byonebros.com
<b>CANADA</b>	Email: cahelp@1byonebros.com
<b>UNITED STATES</b>	Phone: +1 909-391-3888 (Mon-Fri 9:00am - 5:00pm PST) Email: ushelp@1byonebros.com
<b>GERMANY/FRANCE ITALY/SPAIN</b>	Email: euhelp@1byonebros.com

### BRAND OWNER

1byone Products Inc.

1230 E Belmont Street, Ontario, CA, USA 91761

Customer Service: +1 909-391-3888

[www.1byonebros.com](http://www.1byonebros.com)

